

## Specification

Model Number	Depth-Inches	Drain Placement
PS-1812W	6-1/4", 8-1/4"	Central



### SINK DESCRIPTION

Under Counter Mounting sink

Glazing technology holds the advantage of the easy-cleaning Acid and alkali resistant with bright clean surface.

High-temperature firing makes ceramic body tight and Lower water absorption.

Without glaze needs space after, it will be more solid after fixed.

There is a overflow hole on it to prevent water from spilling over the sink.

### CUTOUT DIMENSTIONS

Template included, template number PS-1812W

### PRODUCT COMPLIANCE

All product certified by IAPMO to meet standards ASME A112.19.2-2018/CSA B45.1-18

### WARRANTY

Limited lifetime warranty against material or manufacturing defects to the original consumer purchaser

### TECHNICAL SPECIFICATION

Installation	Under-mount
Bowl area	Length: 20-3/4" ( Outside ) 18-1/2" ( Inside ) Width: 14-5/8" ( Outside ) 12-3/8" ( Inside ) Bowl Depth: 6-1/4", 8-1/4"
Drain Hole	1-1/4" OD
Template	Required, Included

#### Note:

Install this product according to the installation instruction  
Minimum base cabinet size 21"  
Consult an installer for confirmation.

### Installation Detail

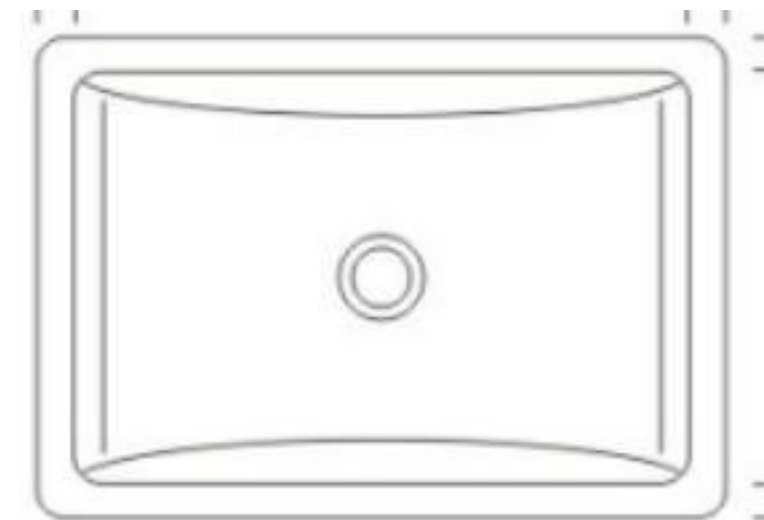
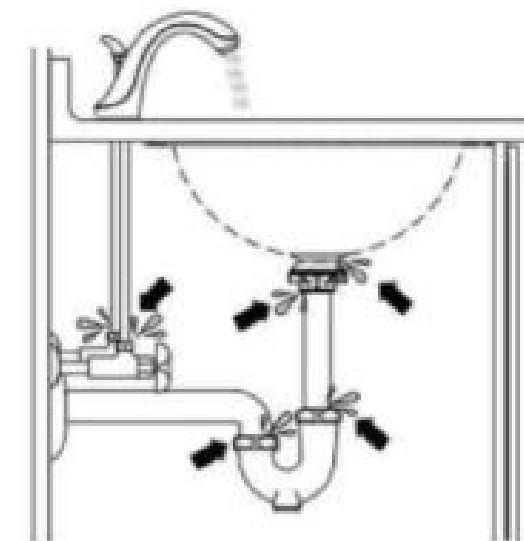
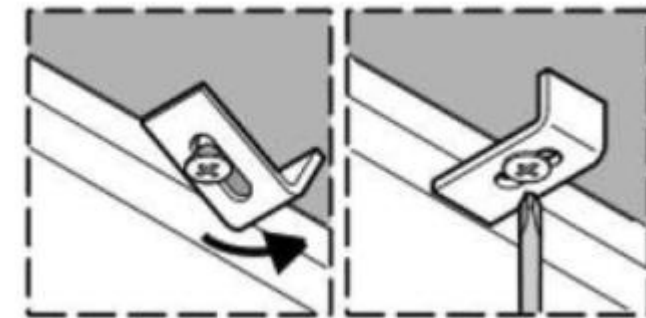

### CRITICAL DIMENSIONS

(DO NOT SCALE)

